



RVR RIPPER SYSTEM



REVOLUTION
BLACK CAT HAMMERLESS PATENTED TECHNOLOGY

- **More Details on Reverse**

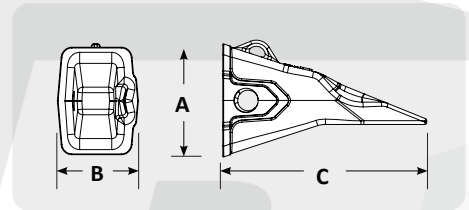
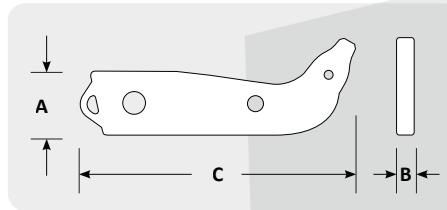
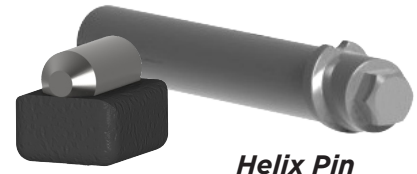

| Part | Part Number | Description | Weight | A | B | C |
|---------|---------------|--------------------|----------|--------|-------|--------|
| RVR 350 | RVR 1380797* | Shank | 125 lbs | 6.86" | 2.92" | 28.24" |
| | RVR 350NOSE | Nose | 17 lbs | 6.10" | 2.92" | 8.30" |
| | RVR 350PTM | Tooth | 29 lbs | 6.17" | 4.72" | 14.13" |
| | RVR 350PTMC12 | Tooth with Carbide | 31 lbs | 6.17" | 4.72" | 14.13" |
| RVR 500 | RVR 1182140** | Shank | 1619 lbs | 15.75" | 3.94" | 98.66" |
| | RVR 500SEG ** | Nose | 146 lbs | 12.61" | 3.96" | 20.47" |
| | RVR 500RR | Tooth | 71 lbs | 8.75" | 6.18" | 19.00" |

NOTE: *Replaces 1380797 & 9J3139

**Replaces 1038115

RVR 1380797



- **Fully Stabilized Nose & Pocket**
- **Hammerless Pin for Safe & Easy Installation**
- **Patented Technology**



Hammerless Pin & Lock

- Fully hammerless installation & removal for safe and easy use.
- Accept both imperial or metric socket, female square drive on opposite end.
- Lock and pin may be used on either side of nose.
- Locks with 180° clockwise turn of pin with socket wrench.
- Pin removal pulls out excess material around the pin head.

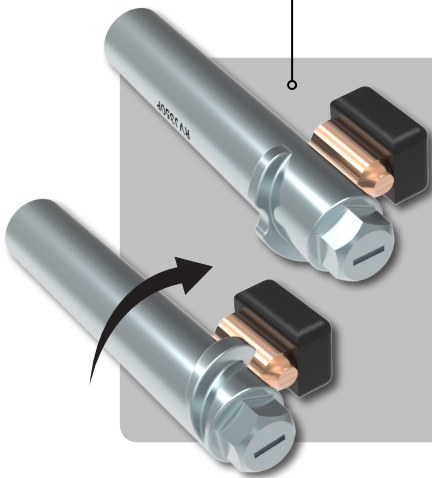

Fully Stabilized Nose & Tooth Pocket

- Primary contact for frontal loads. Bottom out fit with pocket mitigates fit erosion through service life.
- Secondary contact areas for off center frontal loads. Planer bearing areas provide longer service life.
- Redundant frontal load bearing if the primary and secondary areas are worn from tooth overuse.
- Front = Primary bearing area for vertical tooth loads. Rear (opposite side) = Reactive load bearing area for vertical loads.
- V design forces the tooth to center on the nose when heavy side forces are encountered. Preventing pin loading and increases fit integrity.

